

SL-ASR1616HC

The Aesir 1616HC is a sleek dual-bend linear neon with the added glare-protection of a built-in honeycomb louvre across the face of the lit surface.

The slim width of 16mm is the perfect size to be a slim-line linear system but not generate glare from having too higher output from an aperture that is too narrow.

Aesir 1616HC is IP67 & IK06 and features a 50,000hrs or 5 year warranty.

The colour choice is at peak performance, with CRI-90 as standard across a range of fixed-white CCT options to choose from.

Installation is via single bracket, clear top-bracket, fixed channel, or flexible continuous bracket.



code	SL-ASR1616HC
power	14W/m
driver	remote
LED	opal silicon 50° honeycomb louvre
IP rating	IP67
warranty	5 year warranty
flex	Dual-bend – max 5m run

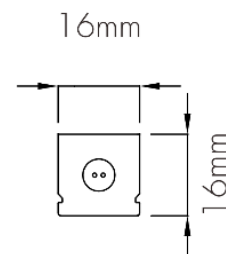

OPTIONS	COLOUR	RATINGS	LED LIFE	CONTROL
Single colour CCT	White body, black HC	IP67 IK06	50,000hrs	Fixed DALI Casambi

mounting options

flexible bracket



fixed clip



aluminium fixed channel



clear clip

